

SAMSUNG

SER-6500II

SYSTEM TERMINAL



Dependability and value for food service operators

Rugged hardware and versatile software bundled in a low-cost terminal. Use standalone, or as part of a modular system. Features compatibility with off-the-shelf options to take advantage of current technology and to provide you with the best value.

The attractive, low profile design leads the list of features for this easy-to-use terminal. An alpha/numeric display spells out items as they are entered and assists operators with clear understandable error messages. The built-in high speed dot-matrix printer provides legible receipts, sales journals and reports.

SER-6500II FAST FOOD SYSTEM

A feature set designed to fit the requirements of single store or multi-unit fast food operators...

Fast Order Entry

A large 160 key position user-friendly keyboard provides enough preset PLU keys for even the largest menus. Size and modifier functions enable operators to access even more items by building a PLU with a few logical keystrokes. For example, the key sequence: large (size key), 3-topping (modifier key), pizza (PLU key) would access a unique PLU for a large 3-topping pizza. Up to five different modifier and five size keys can be used to describe items such as drinks, soft serve or pizzas.

Accurate Sales Information

Promo and waste functions help provide accurate information for inventory analysis. Sales, waste, promo, and total usage is reported for each item.

Employee Time Keeping

You can eliminate the need for a separate time clock by using the Samsung SER-6500II to track employee time. The Samsung SER-6500II tracks up to eight in/out cycles per employee per day, and reports summary time totals for up to 30 labor groups as well as average daily labor costs. If you implement optional PC Polling, employee time data is easily transferred to your host PC.

Full Order Store and Recall

Organize your drive-thru window or phone order system with full-order store and recall functions. Discounts or coupons can be applied; items can be added or voided at the time of pick-up.

Kitchen Printers

Off-the-shelf 40 column Samsung, Citizen, Epson or Star printers can be used to build a truly affordable kitchen printer system. Kitchen printer output programming determines which system printer prints which items. Items can be grouped so different items are routed to different printers. For example, hot food items can be directed to the hot food prep station and drinks to the bar or drink prep station.

- > Industry standard RS-232C interface.
- > Orders may be routed from any system terminal to any printer.
- > Two-color print for requisitions.
- > The Print Key can be used to direct special grill items to the printer for special preparation.

Video Requisition Screens

With standard RS-232C connections, you can attach off-the-shelf hardware that has been enhanced to form a very extensive kitchen preparation and expeditor packing video system.

- > Real-time - Menu items can be sent to the video on the fly to speed service.
- > Eight order screen format for cooking displays only the items to be prepared at that station.
- > Four order screen format displays all items in the order for packing/expediting.

- > Split screen format separates drive-thru and counter orders.
- > Park screen format for the drive-thru holds orders for preparation while other cars move forward.
- > Bump Bars control the screen for clearing or parking orders.
- > Order timing and reporting for drive-thru and counter sales.
- > On screen key item consolidation for efficient food prep during busy periods.



SER-6500II TABLE SERVICE SYSTEM

Guest Check Control

Guest check tracking insures complete server accountability without manual check audits. In addition, you'll eliminate the previous balance pick-up errors common to manual posting systems. If your system requires multiple terminals, Samsung's standard Ethernet communications lets you recall balances from any terminal in your system.

- > Tracking system utilizes table numbers, pre-printed check numbers, or automatically assigns check numbers.
- > Guest count can be enforced upon opening checks.
- > Checks can be paid at any time; items can be added and checks paid inside the same transaction.
- > Guest Check Printing – Soft Check (40 column RS-232C printers) or Hard Check (RS-232C check printer, such as Epson TM295).
- > Tips can be entered, or calculated by percentage.
- > Previous balance, check number, table number, guest count, service, add check, print check and charge tip functions.

Soft Check System

Eliminate the need for expensive custom printed guest checks with the Samsung Soft Check system. Attach an off-the-shelf roll printer to one of the standard RS-232C ports on the SER-6500II. Your servers simply enter items as they are ordered. Stored in the system memory, the computer guest check can be printed or reprinted at any time.

Server Control

- > Up to 99 servers.
- > Open check reporting by server.
- > Full media reporting by server, including service, check paid, tips, etc.



System Configuration

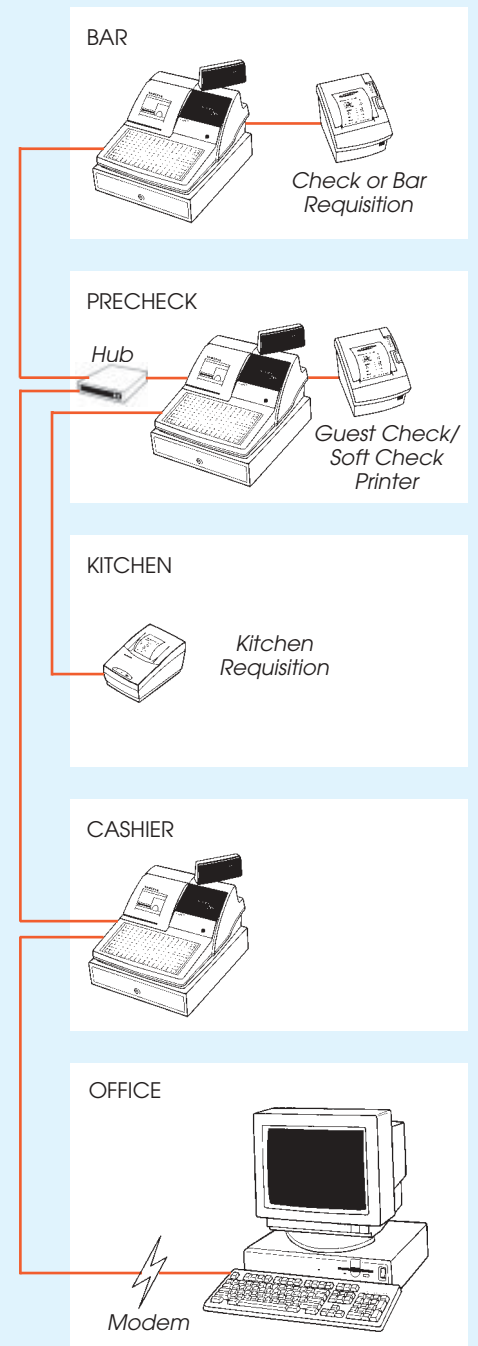

Up to 16 SER-6500II Terminals Per System
Up to 4 Peripherals Per Terminal

SYSTEM REPORTING

Reporting Features

> Report Levels

Two reporting levels (Z1 and Z2) are standard for system reports. Typically Z1 and Z2 are used to provide daily and periodic reports. Optionally, a third level of reporting (Z3) can be added to provide, for example, daily and monthly, as well as year-to-date reports. (Z3 reporting can require additional memory, depending upon your system memory requirements and memory allocation.)

> Group Reports

PLUs can be reported to up to 99 group totals. Groups can provide a quick picture of sales and trends. An item's sales can be reported to 3 different sales groups simultaneously. This allows, for example, sales reporting by department, sub-department, and vendor.

> String Reports

Through system options, the SER-6500II provides considerable flexibility in customizing report contents. "String" reports can be programmed to execute a series of reports. String reports can be scheduled to run at specific times.

Management Reports

- > Financial
- > Sales by Hour
- > All PLU
- > From/To PLU
- > All Clerk
- > Individual Clerk
- > Cash, Check, and Food Stamp in Drawer
- > Sales Group
- > Labor Group
- > Sales by Day (For 31 Days)
- > Time Keeping (All or Individual Clerk)
- > Open Check (All or Individual Clerk)
- > PLU by Group

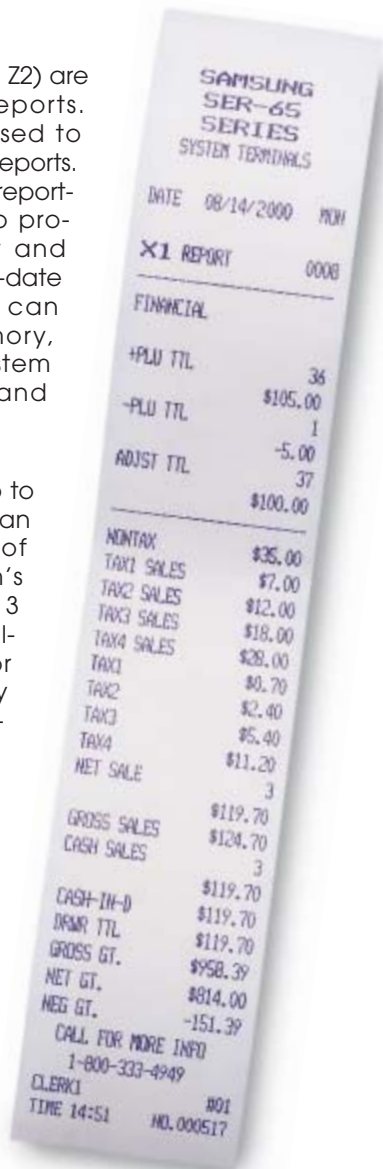

All product features are subject to change without notice.



call: 561-582-5510 email: info@cashregisterservices.net

SYSTEM FEATURES

Standard Inter-Register Communication (IRC)

- > High Speed Ethernet
- > Up to 16 Terminals in the Same Network
- > Program Downloading
- > Report Consolidation

RS-232C Communication

- > Two Standard Ports
- > Two Optional Ports
- > Kitchen Printers (40 column RS-232C printers)
- > Kitchen Requisition Videos
- > Guest Check Printers
- > PC Polling
- > Pole Display
- > Scanner
- > Coin Changer
- > Scale

Optional Memory

- > 512KBytes Standard Memory
- > 1536KBytes Optional Memory
- > Over 15,000 PLUs
- > Up To 99 Clerks/Servers

Keyboard Features

- > 160 Key Positions
- > Up To 130 PLU Keys
- > Size and Modifier Functions
- > Waste and Promotion Functions
- > Up To 40 Macro Keys
- > Cancel Transaction
- > Cash, Check, and Up To 8 Charge Tenders
- > Eat-In, Take-Out, Drive-Thru Functions
- > Currency Conversion For Two Foreign Currencies
- > Up To 10 Discount or Coupon Keys
- > Time-In/Time-Out For Employee Time Keeping
- > Food Stamp Function

Programmable Features

- > Post Tendering
- > Up to 4 Taxes by Tables, Percentage or VAT
- > GST (Canada)
- > Direct Multiplication

- > Code Entry or Push Button Clerks
- > Hash Functions
- > Receipt On Request
- > Check Cashing
- > Split Tendering

Security and Management Control Options

- > Compulsory Cash Declaration
- > Compulsory Closed Cash Drawer
- > Open Drawer Alarm
- > Programmable Rounding Factor
- > Cash-In-Drawer Limit
- > Training Mode
- > Compulsory Validation
- > Management Control (X Key) by Function
- > Multiple Receipts

PLU Programmability

Each PLU is individually programmable for:

- > Compulsory Condiment Entry
- > Print Red/Black on Kitchen Printer (Two color printer required)
- > Enable/Disable Promo Function
- > PLU Group Assignment For Up To 3 of 99 Group Totals (Group assignment is also used to determine output to kitchen printers and/or kitchen videos.)

Specifications

- > Two Line, 12 Character Alpha/Numeric; 10 Character Numeric Display
- > Standard Numeric Customer Display
- > 160 Key Position Keyboard
- > Heavy-Duty Steel 5 Bill/5 Coin Cash Drawer
- > Optional Two or Three Drawer Configuration
- > Optional Deluxe Drawer
- > Heavy-Duty Dot Matrix Printer

